

ABSOLUTE AUCTION

Saturday • Oct. 27th, 2018 • 10:01 am

18.22 ACRES SUBDIVIDED MOUNTAIN VIEW - 6 TRACTS - WATER

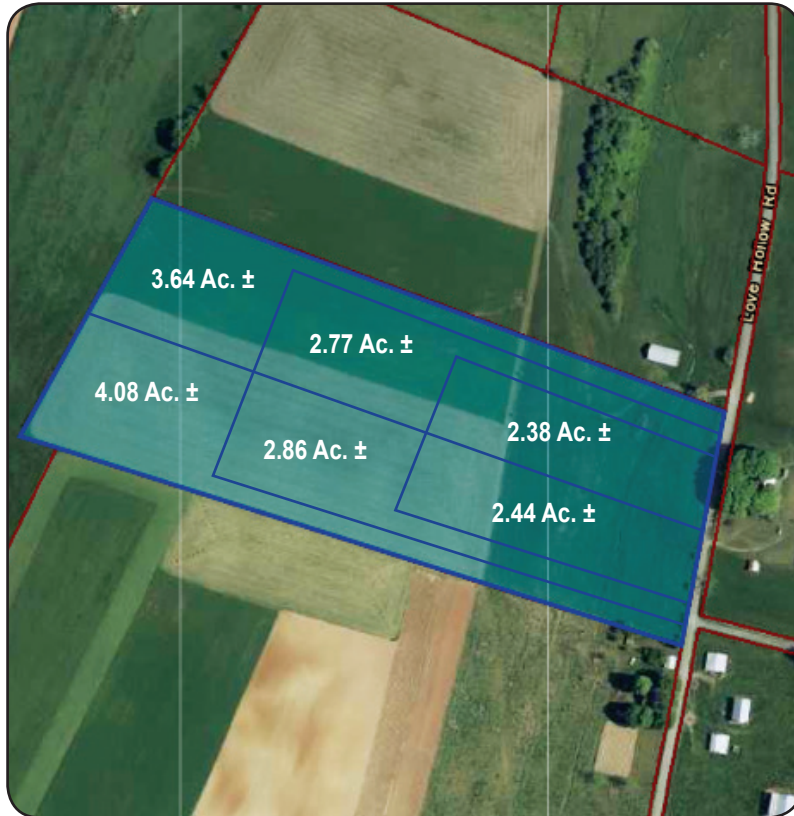

LOCATION: FROM GREENEVILLE OR JONESBOROUGH, on Highway 321 in Tusculum turn onto Tusculum Bypass 107E, continue 3.7 miles, turn left onto Love Hollow Road. Property is on left 6 tenths of a mile.

Property will be offered individually, in groupings and as a whole.

UTILITIES: Chuckey Water District

SCHOOL DISTRICT: Doak Elementary, Chuckey Doak High School

TERMS: 10% Down, balance within 30 days. SEE YOUR BANKER TODAY!

**NO BUYERS
PREMIUM**

AUCTIONEER'S NOTE: All tracts have individual hilltop mountain views. Great area and conveniently located to Greeneville, Jonesborough, Tusculum and the Tri-cities area. Great possibilities for a Gentleman's Farm or house lot. Mr. Builder: Many options. Mr. Investor: Extreme possibilities. **BUILD YOUR DREAM HOME IN AN EXCELLENT LOCATION!**

SALE BEING CONDUCTED FOR LANNY & BETTY LOVE BY:

C.L.A.S.S.

CLASSIC LAND & AUCTION SERVICE SPECIALISTS

140 W. Bernard Ave., Suite 1 • Greeneville, TN 37743 • Phone (423) 639-0881 • Firm #351

AUCTIONEERS: Eddie Yokley, Jim Carter, Charles Baines

www.classauction.us

AuctionZip.com ID#47188

Announcements day of sale take precedence over all printed material.